

STYLE CPS CAPPED PISTON T-SEALS

A heavy duty double-acting assembly, the capped piston T-seal exhibits excellent sealability, extrusion resistance, and wearability. T-seals with "BR" suffix utilize a Bronze Filled PTFE cap instead of the standard Glass Filled PTFE cap.

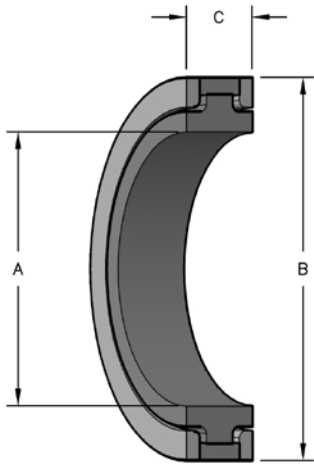

PART NUMBERS

CPS - 1750BR
 Prefix Bore Size

SEAL INFORMATION	
MATERIAL	PTFE CAP NYLON BACK-UP RUBBER ENERGIZER
TEMPERATURE RANGE	-40° TO +220° F
PRESSURE RANGE	0 TO 6,000 psi
SPEED	4.5 FT/SEC

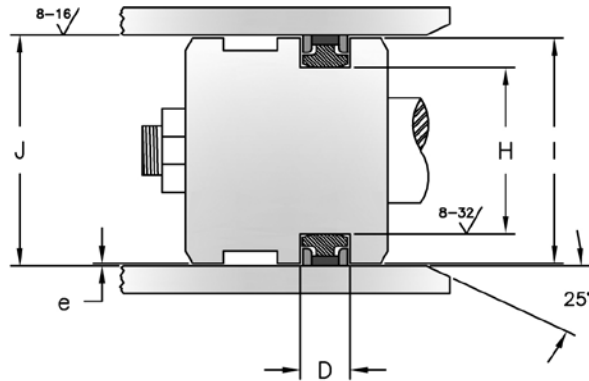

Part Number	A Nom. ID	B Nom. OD	C Nom. Ht	D GROOVE WIDTH	H GROOVE DIAMETER	I PISTON DIAMETER	I PISTON DIAMETER W/WR	J BORE DIAMETER
CPS-1750BR	1.376	1-3/4	.424	.424 ^{+0.010} / _{+0.000}	1.376 ^{+0.000} / _{-.002}	1.749 ^{+0.000} / _{-.006}	1.749 ^{+0.000} / _{-.024}	1.750 ^{+0.002} / _{+0.000}
CPS-2000	1.626	2	.424	.424 ^{+0.010} / _{+0.000}	1.626 ^{+0.000} / _{-.002}	1.999 ^{+0.000} / _{-.006}	1.999 ^{+0.000} / _{-.024}	2.000 ^{+0.002} / _{+0.000}
CPS-2500	2.126	2-1/2	.424	.424 ^{+0.010} / _{+0.000}	2.126 ^{+0.000} / _{-.002}	2.499 ^{+0.000} / _{-.006}	2.499 ^{+0.000} / _{-.024}	2.500 ^{+0.002} / _{+0.000}
CPS-2750BR	2.376	2-3/4	.424	.424 ^{+0.010} / _{+0.000}	2.376 ^{+0.000} / _{-.002}	2.749 ^{+0.000} / _{-.006}	2.749 ^{+0.000} / _{-.024}	2.750 ^{+0.002} / _{+0.000}
CPS-3000A	2.442	3	.42	.420 ^{+0.010} / _{+0.000}	2.442 ^{+0.000} / _{-.002}	2.999 ^{+0.000} / _{-.006}	2.999 ^{+0.000} / _{-.029}	3.000 ^{+0.003} / _{+0.000}
CPS-3000	2.52	3	.579	.579 ^{+0.010} / _{+0.000}	2.520 ^{+0.000} / _{-.003}	2.999 ^{+0.000} / _{-.006}	2.999 ^{+0.000} / _{-.029}	3.000 ^{+0.003} / _{+0.000}
CPS-3000BR	2.52	3	.579	.579 ^{+0.010} / _{+0.000}	2.520 ^{+0.000} / _{-.003}	2.999 ^{+0.000} / _{-.006}	2.999 ^{+0.000} / _{-.029}	3.000 ^{+0.003} / _{+0.000}
CPS-3250	2.77	3-1/4	.579	.579 ^{+0.010} / _{+0.000}	2.770 ^{+0.000} / _{-.003}	3.249 ^{+0.000} / _{-.006}	3.249 ^{+0.000} / _{-.029}	3.250 ^{+0.003} / _{+0.000}
CPS-3500A	2-15/16	3-1/2	.4	.433 ^{+0.010} / _{+0.000}	2.937 ^{+0.000} / _{±0.003}	3.499 ^{+0.000} / _{-.006}	3.499 ^{+0.000} / _{-.029}	3.500 ^{+0.003} / _{+0.000}
CPS-3500	3.02	3-1/2	.579	.579 ^{+0.010} / _{+0.000}	3.020 ^{+0.000} / _{-.003}	3.499 ^{+0.000} / _{-.006}	3.499 ^{+0.000} / _{-.029}	3.500 ^{+0.003} / _{+0.000}
CPS-3500BR	3.02	3-1/2	.579	.579 ^{+0.010} / _{+0.000}	3.020 ^{+0.000} / _{-.003}	3.499 ^{+0.000} / _{-.006}	3.499 ^{+0.000} / _{-.029}	3.500 ^{+0.003} / _{+0.000}
CPS-3750	3.27	3-3/4	.579	.579 ^{+0.010} / _{+0.000}	3.270 ^{+0.000} / _{-.003}	3.749 ^{+0.000} / _{-.006}	3.749 ^{+0.000} / _{-.029}	3.750 ^{+0.003} / _{+0.000}
CPS-4001	3.384	4	.271	.288 ^{+0.005} / _{+0.000}	3.384 ^{+0.000} / _{-.003}	3.999 ^{+0.000} / _{-.002}	3.999 ^{+0.000} / _{-.029}	4.000 ^{+0.002} / _{+0.000}
CPS-4000-288	3.384	4	.288	.288 ^{+0.010} / _{+0.000}	3.384 ^{+0.000} / _{-.002}	3.999 ^{+0.000} / _{-.006}	3.999 ^{+0.000} / _{-.029}	4.000 ^{+0.003} / _{+0.000}

T-SEALS



STYLE CPS CAPPED PISTON T-SEALS

Part Number	A Nom. ID	B Nom. OD	C Nom. Ht	D GROOVE WIDTH	H GROOVE DIAMETER	I PISTON DIAMETER	I PISTON DIAMETER W/WR	J BORE DIAMETER
CPS-4000	3.52	4	.579	.579 ^{+0.010} / _{+0.000}	3.520 ^{+0.000} / _{-.003}	3.999 ^{+0.000} / _{-.006}	3.999 ^{+0.000} / _{-.029}	4.000 ^{+0.003} / _{+0.000}
CPS-4000BR	3.52	4	.579	.579 ^{+0.010} / _{+0.000}	3.520 ^{+0.000} / _{-.003}	3.999 ^{+0.000} / _{-.006}	3.999 ^{+0.000} / _{-.029}	4.000 ^{+0.003} / _{+0.000}
CPS-4250	3.77	4-1/4	.579	.579 ^{+0.010} / _{+0.000}	3.770 ^{+0.000} / _{-.003}	4.249 ^{+0.000} / _{-.006}	4.249 ^{+0.000} / _{-.029}	4.250 ^{+0.003} / _{+0.000}
CPS-4500	4.02	4-1/2	.579	.579 ^{+0.010} / _{+0.000}	4.020 ^{+0.000} / _{-.003}	4.499 ^{+0.000} / _{-.007}	4.499 ^{+0.000} / _{-.029}	4.500 ^{+0.003} / _{+0.000}
CPS-4500BR	4.02	4-1/2	.579	.579 ^{+0.010} / _{+0.000}	4.020 ^{+0.000} / _{-.003}	4.499 ^{+0.000} / _{-.007}	4.499 ^{+0.000} / _{-.029}	4.500 ^{+0.003} / _{+0.000}
CPS-4750A	4.192	4-3/4	.42	.420 ^{+0.010} / _{+0.000}	4.192 ^{+0.000} / _{-.002}	4.749 ^{+0.000} / _{-.007}	4.749 ^{+0.000} / _{-.036}	4.750 ^{+0.003} / _{+0.000}
CPS-4750	4.27	4-3/4	.579	.579 ^{+0.010} / _{+0.000}	4.270 ^{+0.002} / _{+0.000}	4.749 ^{+0.000} / _{-.007}	4.749 ^{+0.000} / _{-.036}	4.750 ^{+0.002} / _{+0.000}
CPS-5000	4.27	5	3/4	.750 ^{+0.010} / _{+0.000}	4.270 ^{+0.000} / _{-.004}	4.999 ^{+0.000} / _{-.008}	4.999 ^{+0.000} / _{-.029}	5.000 ^{+0.004} / _{+0.000}
CPS-5000BR	4.27	5	3/4	.750 ^{+0.010} / _{+0.000}	4.270 ^{+0.000} / _{-.004}	4.999 ^{+0.000} / _{-.008}	4.999 ^{+0.000} / _{-.029}	5.000 ^{+0.004} / _{+0.000}
CPS-5000A	4.316	5	.268	.268 ^{+0.010} / _{+0.000}	4.316 ^{+0.000} / _{-.003}	4.999 ^{+0.000} / _{-.008}	4.999 ^{+0.000} / _{-.029}	5.000 ^{+0.003} / _{+0.000}
CPS-5000D	4.52	5	.579	.579 ^{+0.010} / _{+0.000}	4.520 ^{+0.002} / _{+0.000}	4.999 ^{+0.000} / _{-.007}	4.999 ^{+0.000} / _{-.036}	5.000 ^{+0.002} / _{+0.000}
CPS-5250	4.52	5-1/4	3/4	.750 ^{+0.010} / _{+0.000}	4.520 ^{+0.000} / _{-.004}	5.249 ^{+0.000} / _{-.008}	5.249 ^{+0.000} / _{-.029}	5.250 ^{+0.004} / _{+0.000}
CPS-5250A	4.77	5-1/4	.579	.579 ^{+0.010} / _{+0.000}	4.770 ^{+0.002} / _{+0.000}	5.249 ^{+0.000} / _{-.007}	5.249 ^{+0.000} / _{-.036}	5.250 ^{+0.002} / _{+0.000}
CPS-5500	4.77	5-1/2	3/4	.750 ^{+0.010} / _{+0.000}	4.770 ^{+0.000} / _{-.004}	5.499 ^{+0.000} / _{-.008}	5.499 ^{+0.000} / _{-.029}	5.500 ^{+0.004} / _{+0.000}
CPS-5500BR	4.77	5-1/2	3/4	.750 ^{+0.010} / _{+0.000}	4.770 ^{+0.000} / _{-.004}	5.499 ^{+0.000} / _{-.008}	5.499 ^{+0.000} / _{-.029}	5.500 ^{+0.004} / _{+0.000}
CPS-5500A	4.942	5-1/2	.42	.420 ^{+0.010} / _{+0.000}	4.942 ^{+0.000} / _{-.004}	5.499 ^{+0.000} / _{-.008}	5.499 ^{+0.000} / _{-.029}	5.500 ^{+0.004} / _{+0.000}
CPS-5504	5.02	5-1/2	.579	.579 ^{+0.010} / _{+0.000}	5.020 ^{+0.002} / _{+0.000}	5.499 ^{+0.000} / _{-.007}	5.499 ^{+0.000} / _{-.036}	5.500 ^{+0.002} / _{+0.000}
CPS-5504BR	5.02	5-1/2	.579	.579 ^{+0.010} / _{+0.000}	5.020 ^{+0.000} / _{-.004}	5.499 ^{+0.000} / _{-.008}	5.499 ^{+0.000} / _{-.029}	5.500 ^{+0.004} / _{+0.000}
CPS-5750	5.024	5-3/4	3/4	.750 ^{+0.010} / _{+0.000}	5.024 ^{+0.000} / _{-.004}	5.749 ^{+0.000} / _{-.008}	5.749 ^{+0.000} / _{-.029}	5.750 ^{+0.004} / _{+0.000}
CPS-6000	5.27	6	3/4	.750 ^{+0.010} / _{+0.000}	5.270 ^{+0.000} / _{-.004}	5.999 ^{+0.000} / _{-.008}	5.999 ^{+0.000} / _{-.029}	6.000 ^{+0.004} / _{+0.000}
CPS-6000A	5.52	6	.579	.579 ^{+0.010} / _{+0.000}	5.520 ^{+0.000} / _{-.003}	5.999 ^{+0.000} / _{-.008}	5.999 ^{+0.000} / _{-.029}	6.000 ^{+0.003} / _{+0.000}
CPS-6015	5.285	6.015	3/4	.750 ^{+0.010} / _{+0.000}	5.285 ^{+0.000} / _{-.004}	6.014 ^{+0.000} / _{-.008}	6.014 ^{+0.000} / _{-.029}	6.015 ^{+0.004} / _{+0.000}
CPS-6250	5.52	6-1/4	3/4	.750 ^{+0.010} / _{+0.000}	5.520 ^{+0.000} / _{-.004}	6.249 ^{+0.000} / _{-.008}	6.249 ^{+0.000} / _{-.029}	6.250 ^{+0.004} / _{+0.000}
CPS-6250BR	5.52	6-1/4	3/4	.750 ^{+0.010} / _{+0.000}	5.520 ^{+0.000} / _{-.004}	6.249 ^{+0.000} / _{-.008}	6.249 ^{+0.000} / _{-.029}	6.250 ^{+0.004} / _{+0.000}
CPS-6500	5.77	6-1/2	3/4	.750 ^{+0.010} / _{+0.000}	5.770 ^{+0.000} / _{-.004}	6.499 ^{+0.000} / _{-.008}	6.499 ^{+0.000} / _{-.029}	6.500 ^{+0.004} / _{+0.000}
CPS-6504	6.02	6-1/2	.579	.579 ^{+0.010} / _{+0.000}	6.020 ^{+0.000} / _{-.004}	6.499 ^{+0.000} / _{-.008}	6.499 ^{+0.000} / _{-.029}	6.500 ^{+0.004} / _{+0.000}
CPS-6504BR	6.02	6-1/2	.579	.579 ^{+0.010} / _{+0.000}	6.020 ^{+0.000} / _{-.004}	6.499 ^{+0.000} / _{-.008}	6.499 ^{+0.000} / _{-.029}	6.500 ^{+0.004} / _{+0.000}
CPS-7000	6.27	7	3/4	.750 ^{+0.010} / _{+0.000}	6.270 ^{+0.000} / _{-.004}	6.999 ^{+0.000} / _{-.008}	6.999 ^{+0.000} / _{-.029}	7.000 ^{+0.004} / _{+0.000}
CPS-7000BR	6.27	7	3/4	.750 ^{+0.010} / _{+0.000}	6.270 ^{+0.000} / _{-.004}	6.999 ^{+0.000} / _{-.008}	6.999 ^{+0.000} / _{-.029}	7.000 ^{+0.004} / _{+0.000}
CPS-7250BR	6.52	7-1/4	3/4	.750 ^{+0.010} / _{+0.000}	6.520 ^{+0.000} / _{-.004}	7.249 ^{+0.000} / _{-.008}	7.249 ^{+0.000} / _{-.029}	7.250 ^{+0.004} / _{+0.000}
CPS-7500	6.77	7-1/2	3/4	.750 ^{+0.010} / _{+0.000}	6.770 ^{+0.000} / _{-.004}	7.499 ^{+0.000} / _{-.008}	7.499 ^{+0.000} / _{-.029}	7.500 ^{+0.004} / _{+0.000}
CPS-8000	7.27	8	3/4	.750 ^{+0.010} / _{+0.000}	7.270 ^{+0.000} / _{-.004}	7.999 ^{+0.000} / _{-.008}	7.999 ^{+0.000} / _{-.029}	8.000 ^{+0.004} / _{+0.000}
CPS-8000BR	7.274	8	3/4	.750 ^{+0.010} / _{+0.000}	7.274 ^{+0.000} / _{-.004}	7.999 ^{+0.000} / _{-.008}	7.999 ^{+0.000} / _{-.029}	8.000 ^{+0.0045} / _{+0.0000}

T-SEALS



STYLE CPS CAPPED PISTON T-SEALS

Part Number	A Nom. ID	B Nom. OD	C Nom. Ht	D GROOVE WIDTH	H GROOVE DIAMETER	I PISTON DIAMETER	I PISTON DIAMETER W/WR	J BORE DIAMETER	
CPS-8500	7.77	8-1/2	3/4	.750 +0.010 +0.000	7.770 +0.000 -0.004	8.499 +0.000 -0.008	8.499 +0.000 -0.029	8.500 +0.004 +0.000	
CPS-8500BR	7.774	8-1/2	3/4	.750 +0.010 +0.000	7.774 +0.000 -0.004	8.499 +0.000 -0.008	8.499 +0.000 -0.029	8.500 +0.0045 +0.0000	
CPS-9000	8.27	9	3/4	.750 +0.010 +0.000	8.270 +0.000 -0.004	8.999 +0.000 -0.008	8.999 +0.000 -0.029	9.000 +0.004 +0.000	
CPS-10000	9.27	10	3/4	.750 +0.010 +0.000	9.270 +0.000 -0.004	9.999 +0.000 -0.008	9.999 +0.000 -0.029	10.000 +0.004 +0.000	
CPS-10000BR	9.275	10	3/4	.750 +0.010 +0.000	9.275 +0.000 -0.004	9.999 +0.000 -0.008	9.999 +0.000 -0.029	10.000 +0.0051 +0.0000	
CPS-11000BR	10.275	11	3/4	.750 +0.010 +0.000	10.275 +0.000 -0.004	10.999 +0.000 -0.008	10.999 +0.000 -0.029	11.000 +0.0051 +0.0000	
CPS-12000BR	11.275	12	3/4	.750 +0.010 +0.000	11.275 +0.000 -0.004	11.999 +0.000 -0.008	11.999 +0.000 -0.029	12.000 +0.005 +0.000	
CPS-13000BR	12.275	13	3/4	.750 +0.010 +0.000	12.275 +0.000 -0.004	12.999 +0.000 -0.008	12.999 +0.000 -0.029	13.000 +0.005 +0.000	
CPS-14000BR	13.275	14	3/4	.750 +0.010 +0.000	13.275 +0.000 -0.004	13.999 +0.000 -0.008	13.999 +0.000 -0.029	14.000 +0.005 +0.000	
CPS-15000BR	14.275	15	3/4	.750 +0.010 +0.000	14.275 +0.000 -0.004	14.999 +0.000 -0.008	14.999 +0.000 -0.029	15.000 +0.0055 +0.0000	
CPS-16000BR	15.275	16	3/4	.750 +0.010 +0.000	15.275 +0.000 -0.004	15.999 +0.000 -0.008	15.999 +0.000 -0.029	16.000 +0.0061 +0.0000	

T-SEALS

